

MACHINE PARTS LIST OF BC28

FIG. 2: The Parts List of Model BC28 Brush Cutter

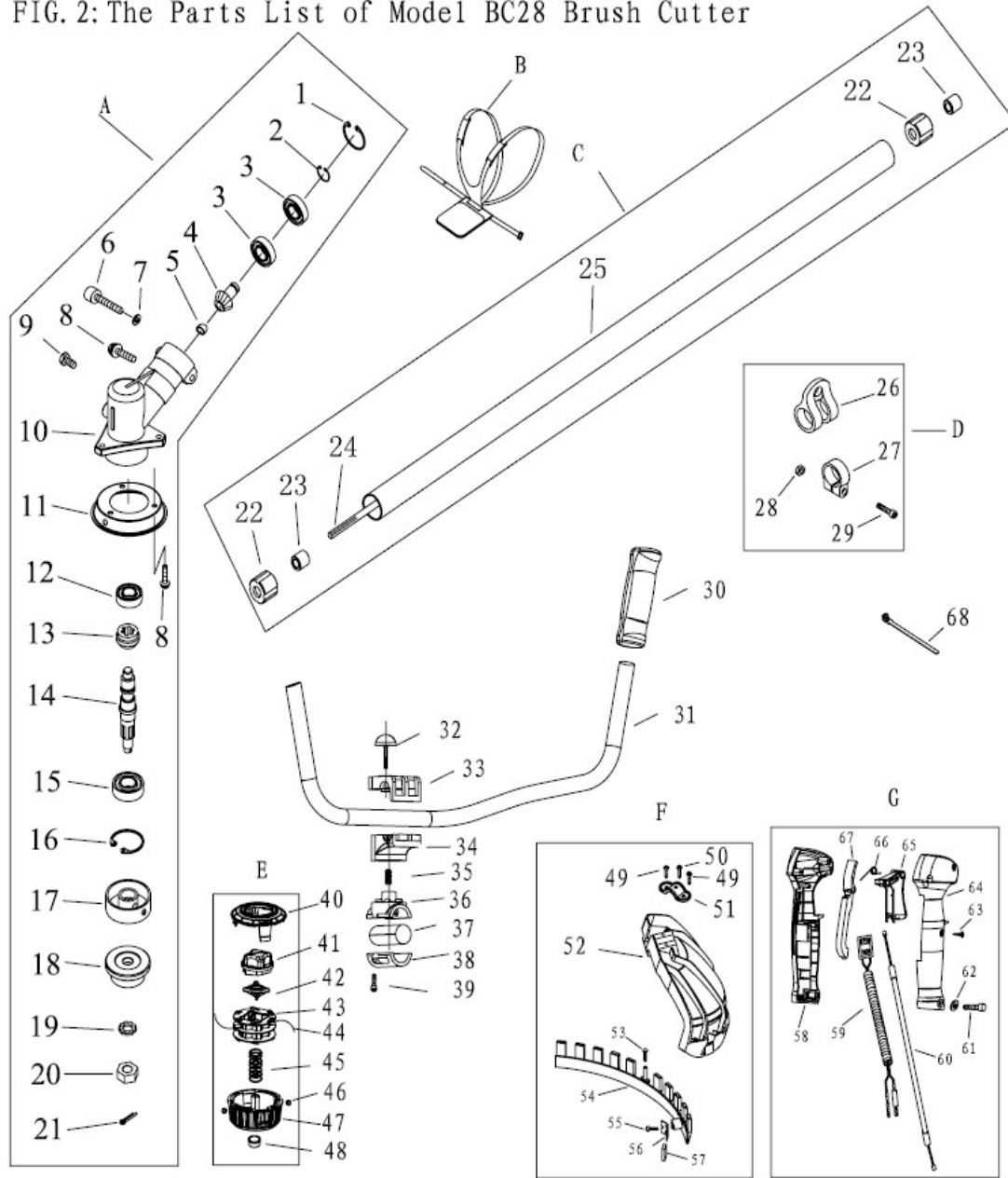

No.	Parts No.	Parts Name	Qty
A	CG415. 3	GEAR CASE ASS' S	1
1	GB/T893. 2	STOP RING 26	1
2	GB/T894. 1	STOP RING 10	1
3	GB/T276	BEARING 6000/P5	2
4	CG415D. 6-4	PINION	1
5	CG415. 3-1	STEEL PLATE CAP	1
6	GB/T70. 1	BOLT M6×20	1
7	GB/T93	WASHER 6	1
8	GB/T9074. 4	BOLT M5×12	4
9	GB/T9074. 11	BOLT M6×12	1
10	BG305. 12. 4-4	GEAR CASE	1

序号	代 号	名 称	数量	序号	代 号	名 称	数量	序号	代 号	名 称	数量
A	CG415.3	GEAR CASE ASS'S	1	23	BG-328.9.4-4	OIL-BEARING	6	46	BC36.5-5	Rope Cover	2
1	GB/T893.2	STOP RING 26	1	24	CG420.2-3	DRIVE SHAFT	1	47	BC36.5.1	Rope Room	1
2	GB/T894.1	STOP RING 10	1	25	BC28.1-1	DRIVE SHAFT PIPE	1	48	BC36.5.1-1	Nut	1
3	GB/T276	BEARING 6000/P5	2	D	CG260.3	Holder Ass'y	1	F	BC36.4	SAFETY GUARD ASS'Y	1
4	CG415D.6-4	PINION	1	26	CG260.3.1	Holder Clamp	1	49	GB/T70.1	BOLT M5*16	2
5	CG415.3-1	STEEL PLATE CAP	1	27	CG260.3-1	Clamp	1	50	GB/T70.1	BOLT M5*10	1
6	GB/T70.1	BOLT M6 × 20	1	28	GB/T889.1	NUT M5	1	51	BC36.4-1	SAFETY GUARD BRACKET	1
7	GB/T93	WASHER 6	1	29	GB/T70.1	BOLT M5 × 20	1	52	BC36.4.1	SAFETY GUARD	1
8	GB/T9074.4	BOLT M5 × 12	4	30	BC36-8	Rubber Ringer	1	53	GB/T845	BOLT ST4.2*16	1
9	GB/T9074.11	BOLT M6 × 12	1	31	BC36-6	HANDGRIP	1	54	CG420.7.1.1-1	Guard	1
10	BG305.12.4-4	GEAR CASE	1	32	BC36.2	Lock Bolt	1	55	GB/T845	BOLT ST4.2*16	2
11	BG330H.7.3-1	BOLT PROTECTION COVER	1	33	BC36-5	CAP, UPPER	1	56	BC46.2.2-1	Blade	1
12	GB/T276	BEARING 6000-2RZ/P5	1	34	BC36-3	BRACKET	1	57	BC46-5	Blade Cover	1
13	BG-328.9.5-2	PINION	1	35	BC36-4	Spring	1	G	BC36.3	Lever Ass'y	1
14	CG305F.1-1	GEAR SHAFT	1	36	BC36-2	Eddy Seat	1	58	BC36.3.3	Box, Left	1
15	GB/T276	BEARING 6002-2RZ/P5	1	37	BC36-10	Damping Cushion	1	59	BC36.3.1	Stop Button Comp.	1
16	GB/T893.2	STOP RING 32	1	38	BC36-1	CAP, Lower	1	60	BC36.3.2	Cable Comp.	1
17	BG305.12.4-5	CUTTER HOLDER CAP	1	39	GB/T70.1	BOLT M5*16	2	61	GB/T818	BOLT M5*30	1
18	CG305F.1-3	CUTTER HOLDER	1	E	BC36.5	Rope Room Ass'y	1	62	GB/T848	WASHER 5	1
19	GB/T862.1	S.WASHER	1	40	BC36.5-2	CAP Rope Room	1	63	GB/T845	BOLT ST3.5*13	4
20	CG305F.1-4	NUT	1	41	BC36.5-1	Bounce Object	1	64	BC36.3-1	Box, Right	1
21	GB/T91	PIN 2 × 16	1	42	BC36.5-3	Rope Cap	1	65	BC36.3-6	Handgrip	1
B	CG260A-CE.1	HARNESS ASS'Y	1	43	BC36.5-4	Rope Seat	1	66	BC36.3-5	Spring	1
C	BC36.1	PIPE COMP.	1	44		Rope	1	67	BC36.3-3	HANDGRIP	1
22	BG-328.9.4-5	RUBBER COVEER	6	45	BC36.5-6	Spring	2	68	BC36-15	WIRE CLAMP BAND	2